

# LYSAGHT® 10 Year Fencing Warranty\*

For your peace of mind

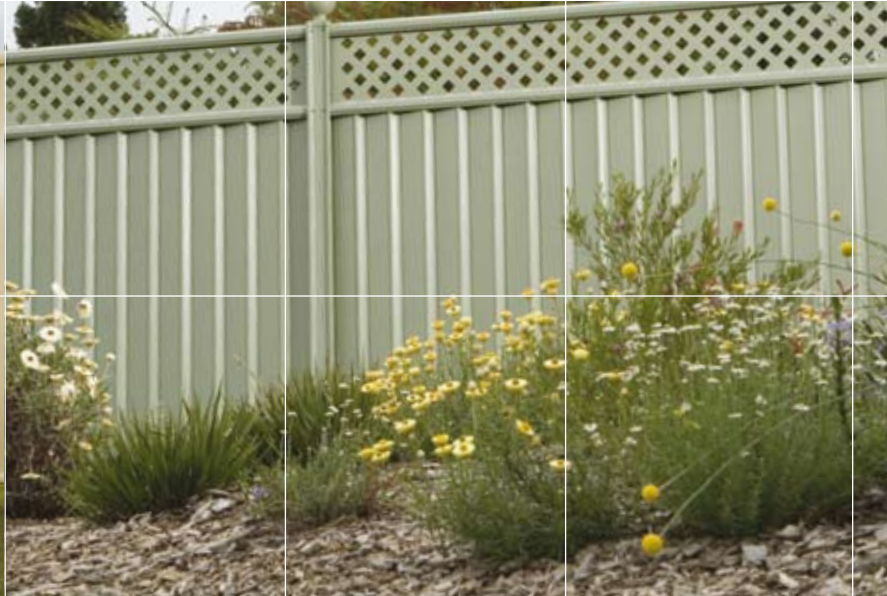

Product performance warranty



# For your piece of mind

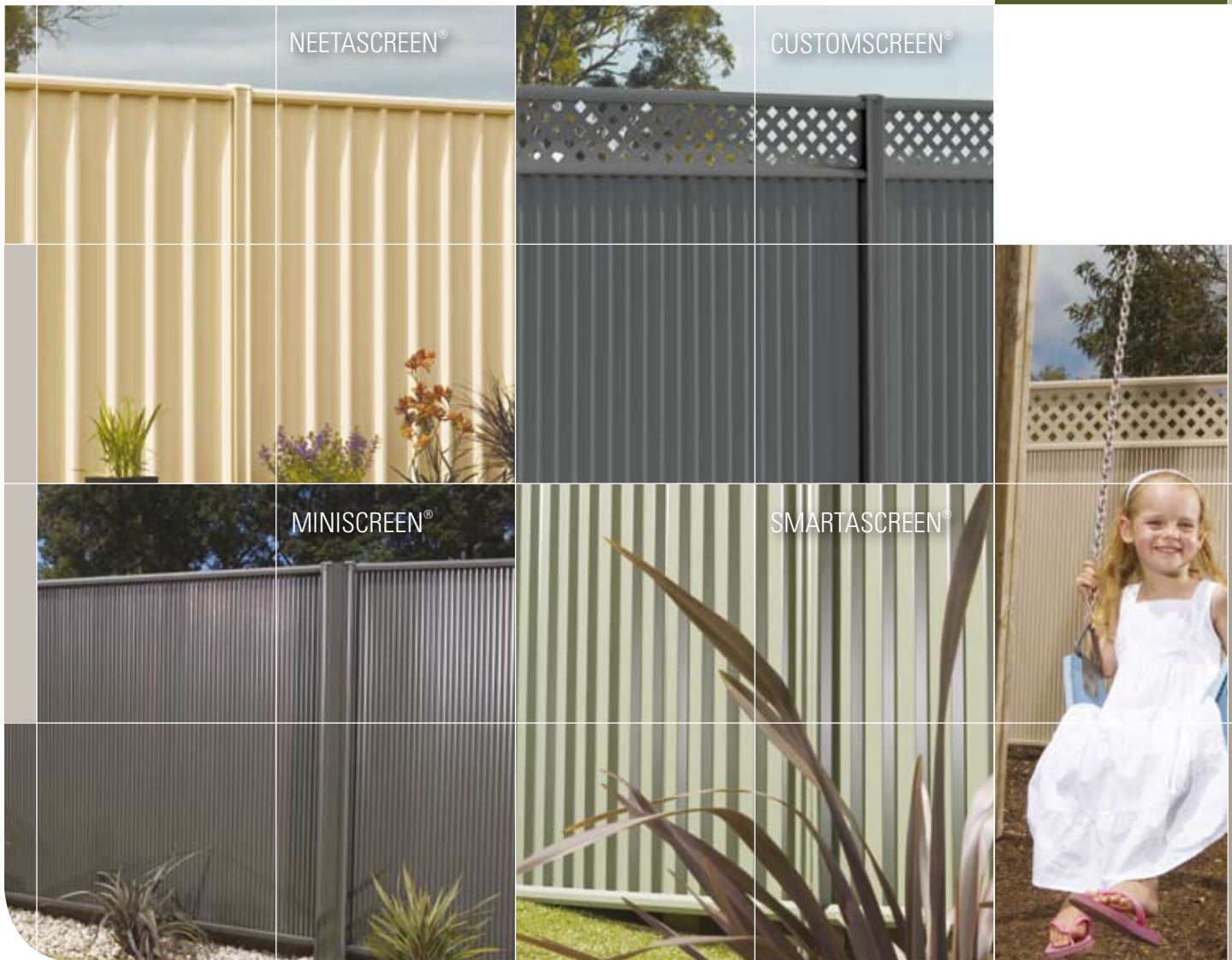

**When you buy your steel fence from BlueScope Lysaght you can be assured you are getting a 100% Australian made product backed by the strength and reputation of one of Australia's leading manufacturers.**

Your purchase of a LYSAGHT® steel fence gives you the protection of two unique warranties for your peace of mind.

1. Your LYSAGHT® 10 Year Fencing Warranty covers the structural integrity of your complete fence system. It's your guarantee that your fence will remain standing for years to come\*; and
2. A separate COLORBOND® steel warranty covers the material used to manufacture your LYSAGHT® modular fence system against corrosion to perforation by weathering in the natural elements, and against paint flake and peel.

\*This LYSAGHT® 10 Year Fence Warranty replaces the LYSAGHT® 10 Year Complete Fence Warranty from 1 April 2010.

# Your LYSAGHT® fence warranty



**BlueScope Steel Limited (trading as BlueScope Lysaght) warrants that, for a period of 10 years from the date of installation, the LYSAGHT NEETASCREEN®, SMARTASCREEN®, MINISCREEN® or CUSTOMSCREEN® fence system including posts and rails used on your property and installed as specified in our documentation (“Product”) is:**

- Manufactured from 100% prime Australian steel from BlueScope Steel;
- Free from all defects in manufacture;
- ‘Fit for purpose’ and will perform as detailed in our published documentation when selected and installed in accordance with our recommendations described in our installation guides;\*\*
- Will resist the Design Wind Pressure calculated in accordance with AS1170.2-2002 (Region A, Regional Wind Speed VR = 45m/sec, Region B, Regional Wind Speed VR = 57m/sec); and
- Complies with the following Australian Standards:
  - AS 1562.1-1992 - Design and Installation of sheet roof and wall cladding - Metal;
  - AS 4040.2-1992 – Methods of testing roof and wall cladding - Resistance to wind pressures for non-cyclone regions;
  - AS/NZS 4600-2005 – Cold-formed steel structures;
  - AS 1170.1-2002 – Structural Design Actions Part 1: Permanent, Imposed & Other Actions;
  - AS 1170.2-2002 – Structural Design Actions Part 2: Wind Actions

*(the above warranty to be referred to as the “LYSAGHT® 10 Year Fence Warranty”)*

If, during the period of the LYSAGHT® 10 Year Fence Warranty, the Product fails to comply with the LYSAGHT® 10 Year Fence Warranty as described above, we will replace or repair, at our option, the part of the Product found by us to be defective (“Remedies”).

\*\*Installation and maintenance details are available at [www.lysaght.com](http://www.lysaght.com)



# Warranty details



## **This LYSAGHT® 10 Year Fence Warranty only applies where:**

1. All component parts of the Product have been supplied or approved by BlueScope Lysaght;
2. The fasteners used in or with the Product conform to AS 3566-2002 Class 3 or better;
3. The Product is selected and installed in accordance with BlueScope Lysaght recommendations described in our fencing installation guide;
4. The Product has been maintained in accordance with the maintenance guidelines contained in this document; and
5. Installation and usage of the Product are in line with requirements of material warranties from BlueScope Steel – for example COLORBOND® and ZINCALUME® steel. More details available from [www.bluescopesteel.com.au](http://www.bluescopesteel.com.au)

## **This LYSAGHT® 10 Year Fence Warranty does not apply:**

1. Where failure of the Product is partly or wholly due to any of the following not caused by BlueScope Lysaght:
  - (a) damage sustained during handling, storage, erection or after erection;
  - (b) maltreatment, neglect or insufficient maintenance;
  - (c) movement of the ground or structural defects of any building;
  - (d) wind speeds greater than those detailed in the LYSAGHT® 10 Year Fence Warranty as described above; or
  - (e) storm, tempest, flood, fire, lightning, other acts of God or anything beyond our reasonable control; or

2. To COLORBOND® steel corrosion to perforation or paint system flake or peel.
3. To lattice, slat, pickets or other “Plus” infill options

## **Excluded Liabilities**

To the extent permitted by law, or BlueScope Lysaght’s liability for any breach of the LYSAGHT® 10 Year Fence Warranty is limited to the Remedies described above and we will not accept liability for any of the following:

1. Injury to persons, or damage to property;
2. Incidental, indirect, special, punitive or consequential loss or damage, loss of profits, loss of revenue, loss arising from interruptions to business, loss of goodwill or business, however they occur; or
3. Installation or labour costs due to either the removal of defective Product or the fixing of replacement Product.

## **Claims under LYSAGHT® 10 Year Fence Warranty**

After a claim is made, we will inspect or arrange for an inspection of the Product. You must provide us or our nominated representative with safe access to the Product to assess whether it gives rise to a legitimate claim under the LYSAGHT® 10 Year Fence Warranty.

# COLORBOND® steel warranty



Purchasing a 100% Australian made LYSAGHT® steel fence means you are also able to apply for a COLORBOND® steel material warranty backed by BlueScope Steel\*.

## Eligibility

Availability and duration of warranties depend on a number of factors, including location and how products were installed.

The online warranty system considers the specifics of your product and will determine if you are eligible for a warranty, and for how long.

## What does your warranty cover?

Depending on eligibility and product application, BlueScope Steel offers a fencing warranty of up to 10 years from the date of installation against corrosion to perforation by weathering in the natural elements. BlueScope Steel also warrants that the paint system will not flake or peel due to natural weathering for up to 10 years. Your official BlueScope Steel Warranty Certificate will advise what your warranty covers and for how long.

## Apply on-line

BlueScope Steel is committed to quality service and support. By applying on-line you will ensure that your warranty is permanently on record. That's peace of mind you can really count on.

## Download and apply for your warranty certificate today

1. Apply at [www.bluescopesteel.com.au/warranties](http://www.bluescopesteel.com.au/warranties)  
Sign up and register your details.
2. Click on the 'Create Actual Warranty' button.
3. Follow the prompts to complete your warranty registration.

\*LYSAGHT® fencing made from COLORBOND® steel should not be used within one kilometre of the ocean or within the splash zone of saltwater or chlorine swimming pools. Your LYSAGHT® 10 Year Fence warranty does not cover the performance of COLORBOND® steel.



# Maintenance guidelines

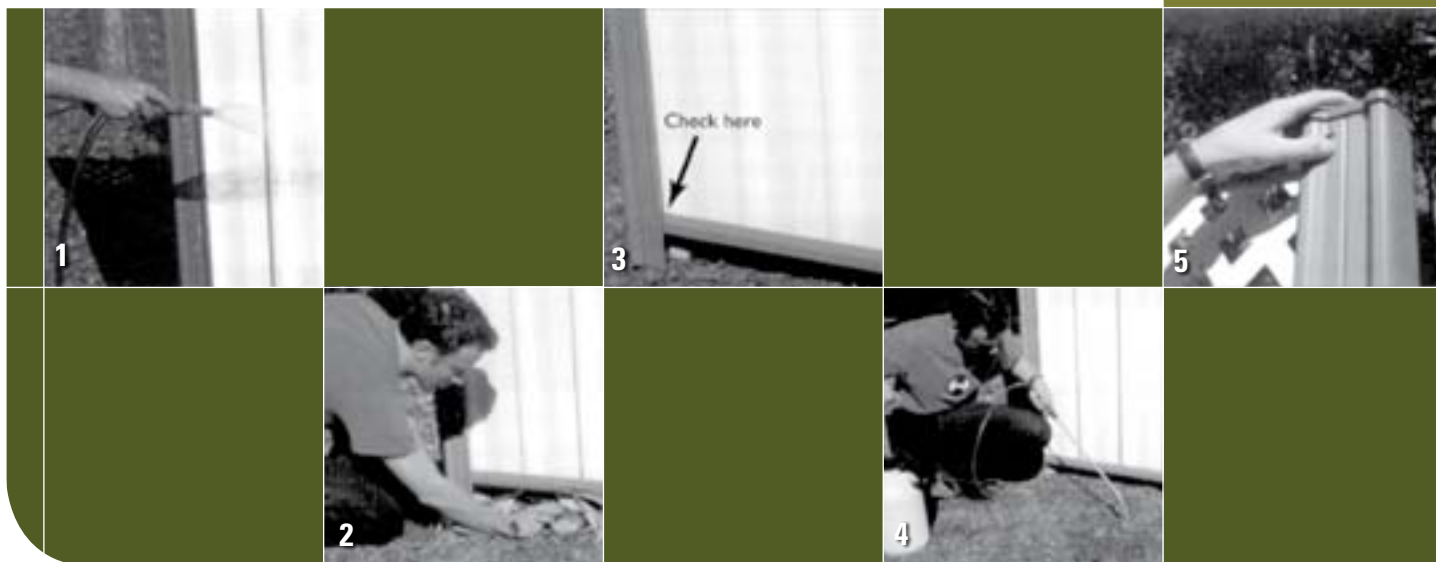

The following maintenance guidelines form part of the warranty conditions and will help maximise the life of your investment. Enjoy your LYSAGHT® steel fence!

Our fences and gates are made from COLORBOND® pre-painted steel. This means that you have bought a strong, long-lasting product. Here are some important tips for you to follow. Immediately after your fence and gate are installed, check that there are no metal chips or filings remaining on the paintwork. You can remove them by hosing and gently wiping with a soft cloth. Also check that your fenceposts have been set in concrete, not directly into the earth.

The pre-painted finish on your fence made from COLORBOND® steel has a good resistance to accidental spilling of common solvents, however you should always wash your hands with water if there is an accident.

1. Regularly wipe or hose your fence and gate – at least once every six months or more if you live in a coastal area (water restrictions permitting).
2. Make sure that the posts, bottom rail and panels are always free of dirt, debris, fertilisers and anything corrosive.

3. There are drainage slots on the underside of your bottom rails. Periodically check that they are clear so water can drain away freely. Don't climb on your fence or otherwise cause the bottom rails to become bent.
4. Always keep overspray from poisons off your fence.
5. Periodically check that all your fence posts have plastic caps on them – they provide protection from sharp edges.

#### Remember...

- If your fence gets splashed with pool water, always hose it down before the pool water dries. BlueScope Steel does not warrant against harmful chemicals, and this includes water from swimming pools, which is corrosive.
- Other materials that you should keep off your fence include lead, copper, monel metal, bare steel, stainless steel, timber and concrete.
- Minor scratches in your paintwork won't affect the performance of your fence. Don't touch-up minor damage with paint because colours are unlikely to match over time.

For more information call **1800 064 584**

Warranty terms and conditions apply. Warranties are not available for all products and applications. The duration, terms and conditions of available warranties vary according to product use and application. To determine the eligibility of your project visit [www.bluescopesteel.com.au/warranties](http://www.bluescopesteel.com.au/warranties) or call 1800 022 999. LYSAGHT, SMARTASCREEN, NEETASCREEN, MINISCREEN, CUSTOMSCREEN, COLORBOND, and BlueScope are registered trade marks of BlueScope Steel Limited, ABN 16 000 011 058. © 2010 BlueScope Steel Limited, ABN 16 000 011 058.



[www.lysaght.com](http://www.lysaght.com)



LYH027 04/10